

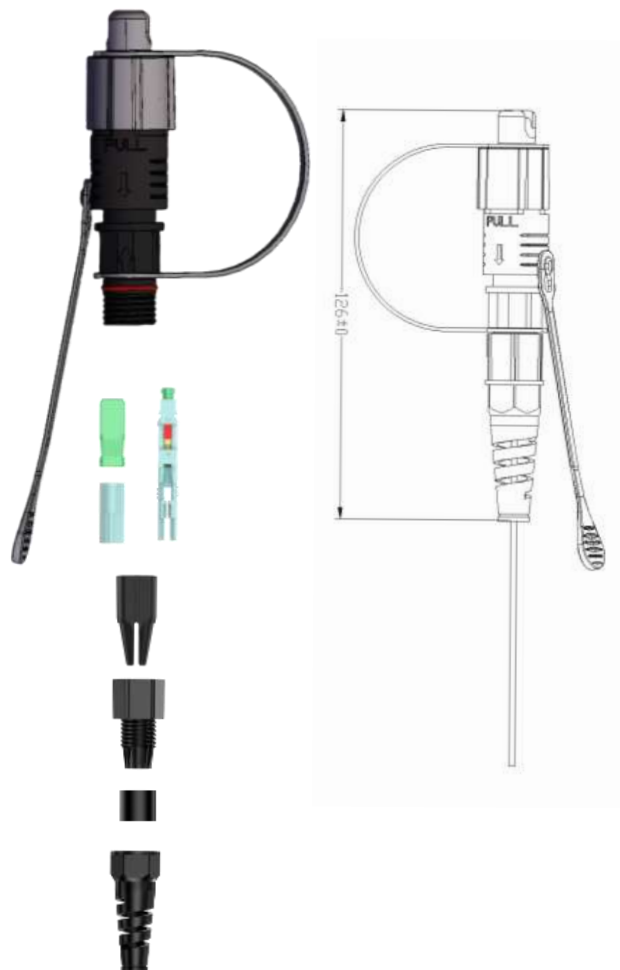

Installation Manual

Reinforced
Fiel Connector One
click compatible for
Flat Drop
5mm*2mm, Round
3mm, Round 5mm

AR-RFC-SCAPC-HC



① Installation Manual

1.1 Indications

To use this product correctly, the instructions must be read carefully before use.
Please assemble the connector according to these instructions, using the matched tools.

1.2 Operation Steps

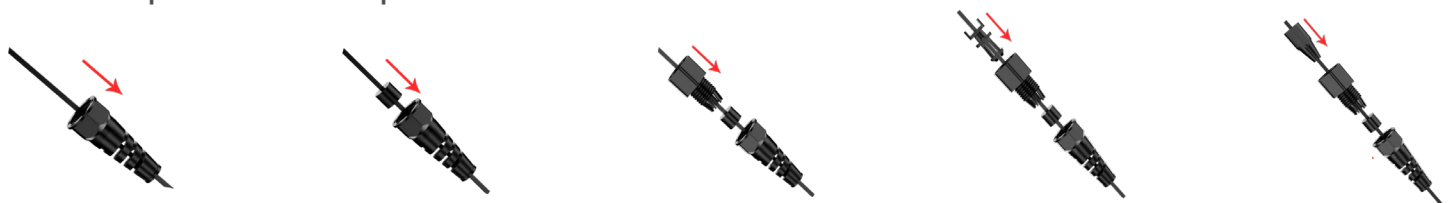

1 Insert the boot

2 Insert the silicone rubber ring

3 Put on the lockdown cap

4.1 Put on the cable clip
3mm*2mm, 3mm

4.2 Put on the cable clip
5mm

5 SC/APC Field Assembly Optical Connector (For 5.0mm Round Drop Cable)

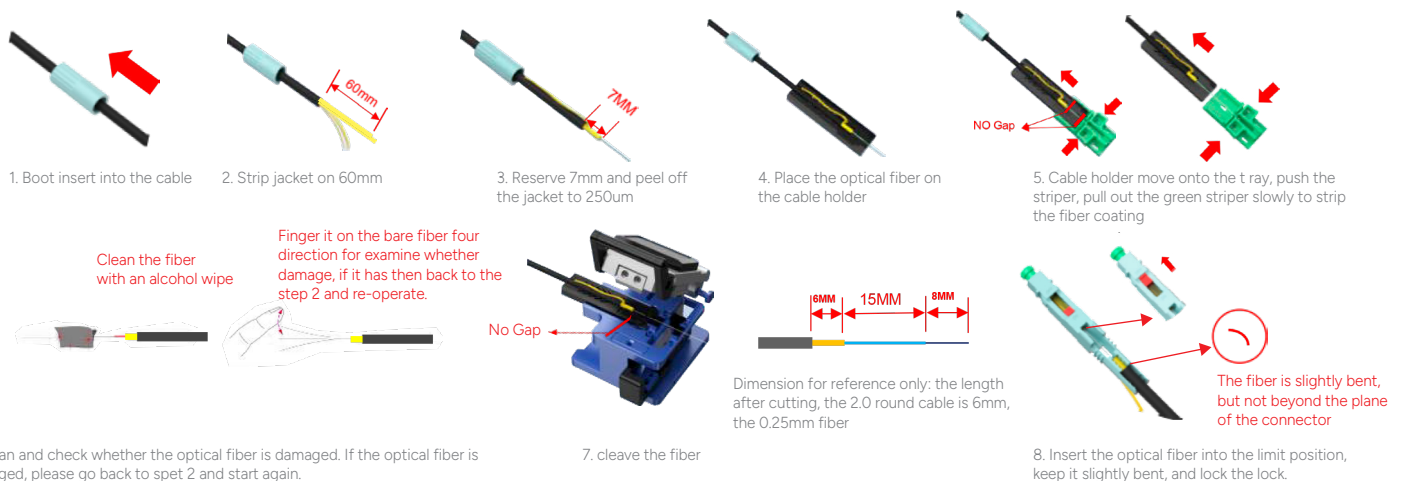

6. Clean and check whether the optical fiber is damaged. If the optical fiber is damaged, please go back to step 2 and start again.

7. cleave the fiber

8. Insert the optical fiber into the limit position, keep it slightly bent, and lock the lock.

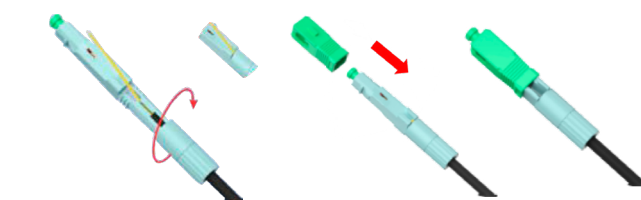

6. Screw on the nut, cut off the excess Kevlar, put on the shell and complete the assembly..

Disassembly steps

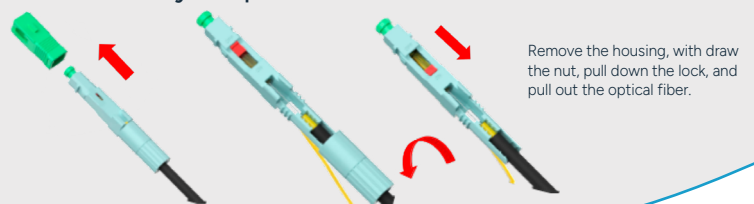

Remove the housing, with draw the nut, pull down the lock, and pull out the optical fiber.

1 Installation Manual

5 SC/APC Field Assembly Optical Connector (For 2.0x3.0 and Fig.8 mm Flat Drop Cable)

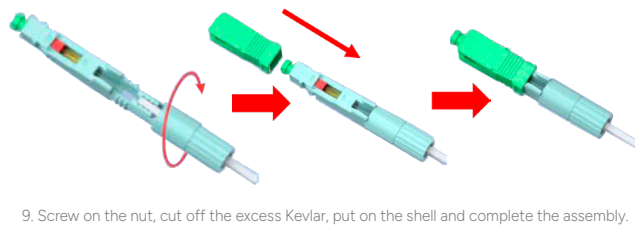
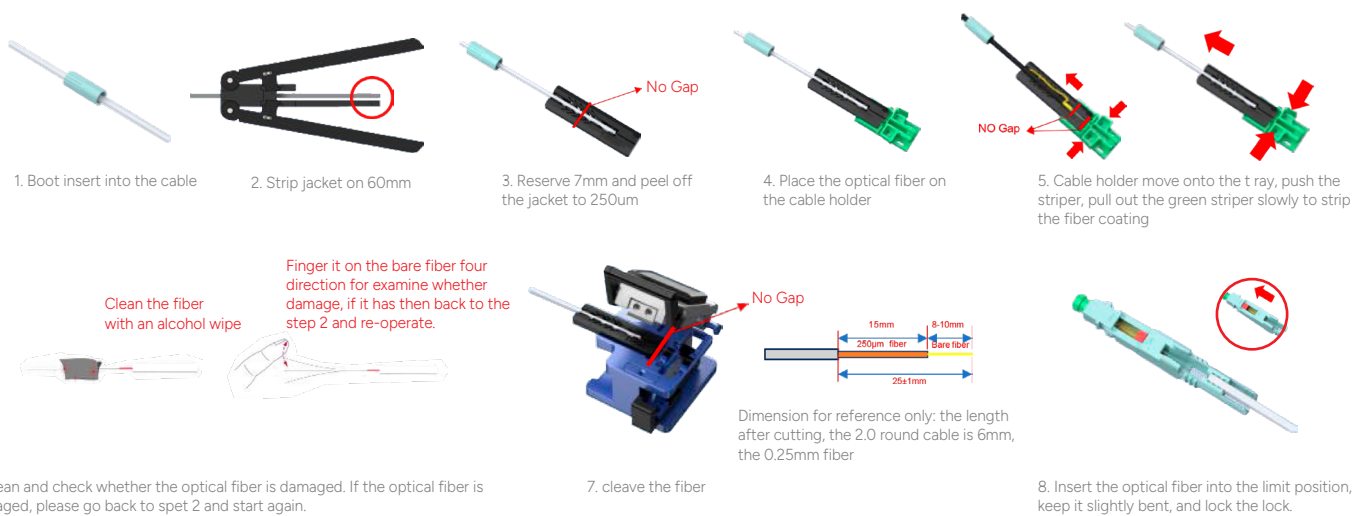

Disassembly steps

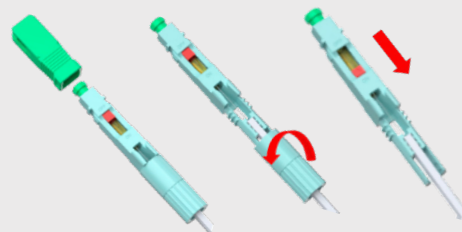

Remove the housing, with draw the nut, pull down the lock, and pull out the optical fiber.

① Installation Manual

1.2 Operation Steps



⑥ Sequence after installation is as shown above



⑦ Align the arrow of the quick connector with the indicator window of the main body (yellow at the triangular notch Circled) Insert the quick connector to the limit.

⑧ Push up the cable clip.

⑨ Screw tight the lockdown cap

⑩ Insert the silicone ring into the end of the lockdown cap

⑪ Tighten the boot, and the assembly is complete.