

V2

High-Precision Fiber Cleaver

OPERATION MANUAL

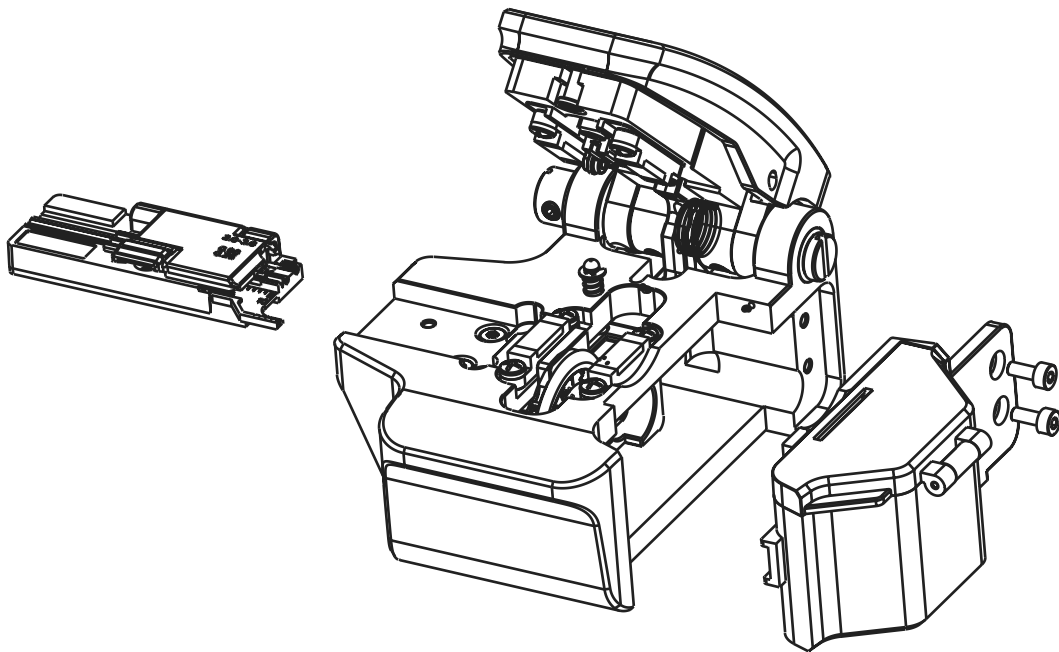

iNNO[®]
INSTRUMENT

v1.1

SAFETY WARNING AND PRECAUTIONS

Thank you for choosing the V2 Fiber Cleaver. To ensure safe and effective use of this device, it is essential to thoroughly read and understand this manual before operation.

⚠ Important Safety Warning:

Failure to adhere to the guidelines in this manual may result in personal injury or damage to the product.

Precautions:

1. Do Not Disassemble or Lubricate:

Attempting to disassemble or apply oil to the main body of the cleaver can lead to product damage.

2. Handle with Care:

Dropping or subjecting the cleaver to impact can impair its functionality.

3. Blade Safety:

Avoid contact with the blade. Touching the blade can cause injury and may damage the blade.

4. Fiber and Shard Management:

Fibers and shards are hazardous. Promptly clean and dispose of any debris to prevent accidents.

5. Disposal of Fiber Debris:

Ensure proper disposal of fiber shards. Have the bin ready for safe disposal.

6. Service and Support:

In case of any operational issues, cease use immediately and contact the INNO Service Center for assistance.

Product Overview

Type	Single fiber
Cladding Diameter	125 μm
Cleared Length	5mm ~ 20mm (Coating diameter \leq 250 μm)
	10mm ~ 20mm (Coating diameter > 250 μm)
Applicable Fiber Cable	Single Fiber: 250 μm to 900 μm and drop cable
Typical Cleaved Angle	0.5°
Typical Blade Life	Total 60,000 fiber cleaves (2,500 cleaves per each point, total 24 points)
Dimensions	90 x 78 x 50 mm
Weight	267g
Step	1

Accessories

Cleaver Case	CC-06
Brush	CB-02
Hexagonal Wrench	CW-03
Quality Report	

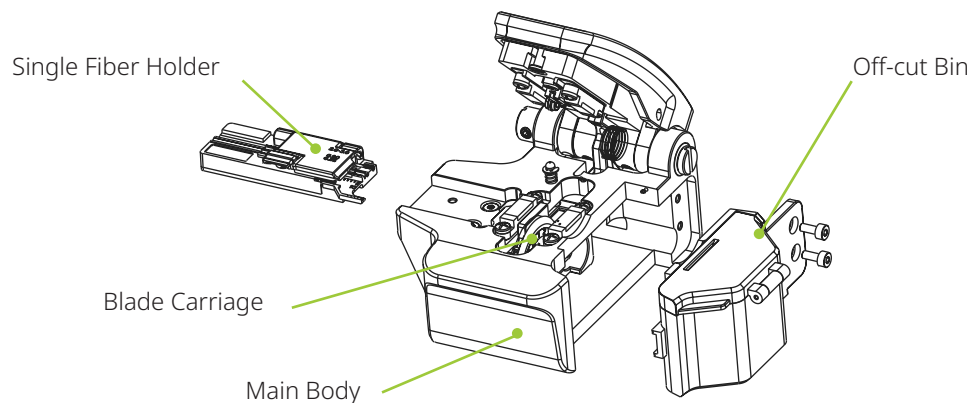

Operating Procedure

1. Open the Fiber Holder lid
2. Place the fiber in the appropriate groove and adjust its position for the required cleave length.

Tip: To achieve 16mm cleave length, the edge of the fiber coating should align with the 16mm marking on the ruler.

3. Cleave the fiber by closing the lid/ cover of the cleaver. The shard should automatically be collected into the Off-cut Bin.
4. Off-cut Bin.

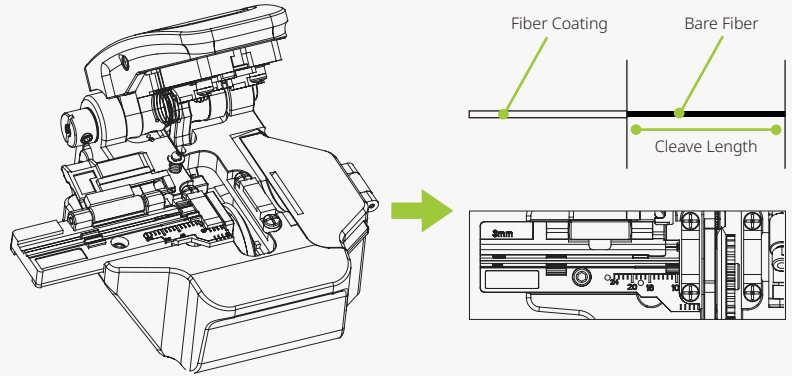

Blade Adjustments

Blade Position

1. Following the first step of the Blade Replacement procedure (Off-cut Bin removal), loosen the blade-holding screw (1) with a T8 wrench.
2. Rotate the blade to the next position
3. Tighten the blade-holding screw (1)
4. Reinstall the Off-cut Bin

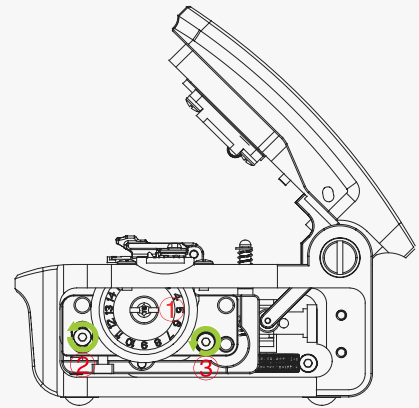

Blade Height

1. Following the first step of the Blade Replacement procedure (Off-cut Bin removal), loosen the side screws (2 & 3), and the locking screw (4).
2. Using the 1.5mm L-shaped wrench, turn the adjustment screw (5). Clockwise to raise the blade, and counter-clockwise to lower it.
3. Tighten the screws (2, 3 & 4)
4. Reinstall the Off-cut Bin

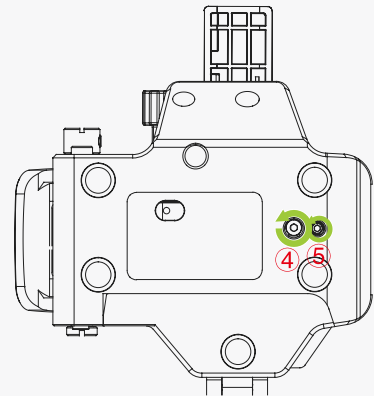

Blade Replacement

1. Use 1.5mm L-shaped wrench to unscrew the 2 screws on the side of the cover (A & B), and remove the Off-cut bin.
2. Unscrew the blade-holding screw (C) with a T8 wrench, replace the blade and secure it in place with the blade-holding screw (C).
3. Reinstall the Off-cut Bin

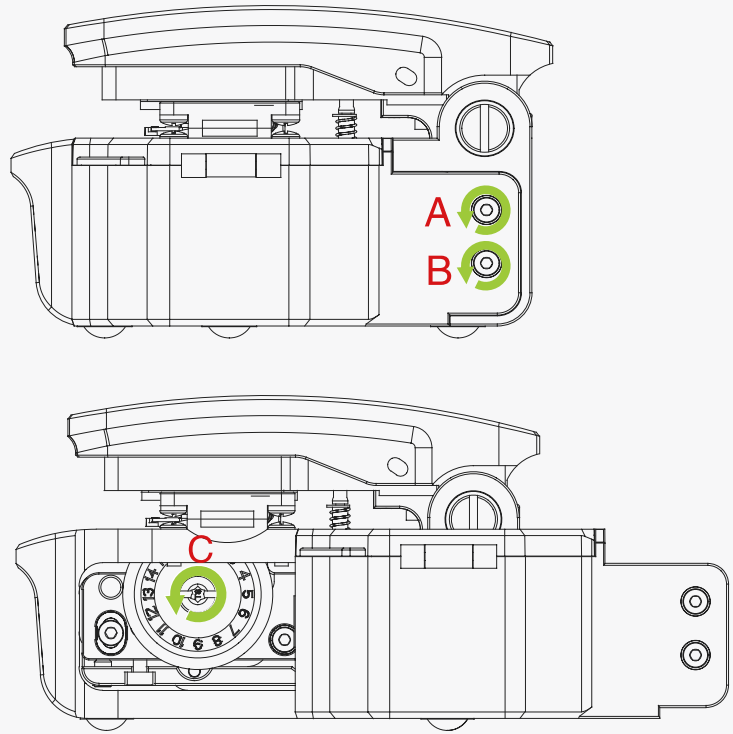

Maintenance

To ensure stable and consistent operation, the cleaver should be kept free of contamination.

Using a cotton swab with alcohol (IPA), clean components. The grooves of the fiber holder should be free from any debris or residue.

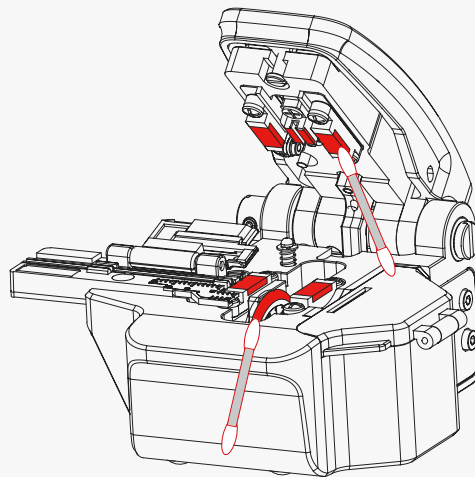

Troubleshooting

If you encounter cleaving problems, consider these common issues and solutions:

1. **Fiber Placement:** Ensure the fiber is properly, straightly placed.
2. **Blade Height:** Adjust the blade to the correct height.
3. **Holder/Clamp Dust:** Clean any dust from the holder and clamp.
4. **Fiber Dust:** Re-strip and clean the fiber with alcohol.

For further assistance, contact the INNO Service Center.